

Deducted No. 2788  
(Sgd.) W.F. Murray  
for Surveyor-General  
Oct. 21. 1912.

Sides		Angles	
ab	270'	a	90°
bc	120'	b	90°
cd	270'	c	90°
da	120'	d	90°

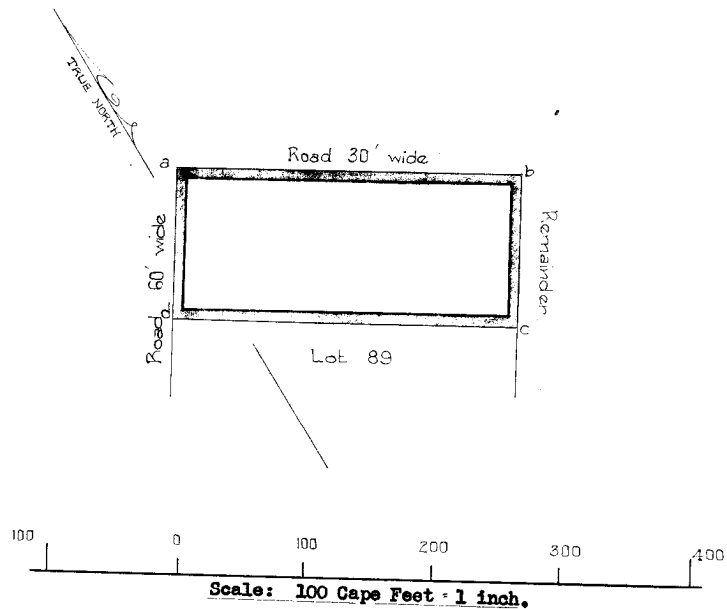

Now Erf No. 90: MERWEVILLE.

The above diagram bordered Green lettered a b c d represents 225 sq. roods of land situate in the Township of MERWEVILLE, Fieldcornetcy Ward No.5 Gough, Division of Beaufort West, Being Lot 90 of the farm Van der Byl's Kraal, granted to J.J. Le Sueur Van der Byl, on the 16th. December, 1901, and transferred to C.F. Snyman and others in their capacity as members for the time being of the Kerkraad of the Dutch Reformed Church of Merweville on the 18th. day of May 1905.

Bounded:- North West by Road 60' wide  
South East " Remainder  
North East " Road 30' wide  
South West " Lot 89

Surveyed and beaconed by me according to Regulations  
(Sgd.) P.S. Dale  
Government Surveyor  
December, 1904.

Copied from the diagram relating to  
Transfer *File Deed No* 11132  
dated 31st. December, 1912. in favour of  
Jacobus Lodewikus Erasmus.  
*M.L. Hardwick*  
3.4.1950. for SURVEYOR-GENERAL  
CAPE TOWN

CHIEF CLERK  
DIVISION OF MERWEVILLE

I.E.B.